

Panasonic

Panasonic

business.panasonic.eu



PROFESSIONAL DISPLAYS

LINE-UP CATALOGUE FEB 2014

PANASONIC PROFESSIONAL DISPLAYS COME IN A WIDE RANGE TO MATCH YOUR NEEDS AND INSTALLATION CONDITIONS.

Panasonic Large 4K Displays will be released in Q3 2014

4K LED Display Preliminary

Outstanding Picture Quality
High Reliability
System Expandability



* Actual resolution : 3,840 x 2,160p



LF Series

High Brightness
24/7 Use Reliability
System Expandability



LF6/LF60
series only



LF50
series only



TH-80LF50
380 W
Approx. 60.0 kg/132.3 lbs
1,848 x 1,073 x 89 mm/
72.8" x 42.3" x 3.5"



TH-70LF50
260 W
Approx. 47.0 kg/103.6 lbs
1,604 x 931 x 89 mm/
63.2" x 36.7" x 3.5"



TH-55LF60
150 W
Approx. 25.8 kg/56.9 lbs
1,248 x 718 x 68 mm/
49.1" x 28.3" x 2.7"



TH-47LF60
140 W
Approx. 16.7 kg/36.9 lbs
1,076 x 621 x 68 mm/
42.4" x 24.5" x 2.7"



TH-42LF60
125 W
Approx. 14.5 kg/32.0 lbs
967 x 560 x 68 mm/
38.1" x 22.1" x 2.7"

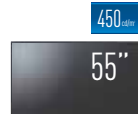

TH-55LF6
150 W
Approx. 25.8 kg/56.9 lbs
1,248 x 718 x 68 mm/
49.1" x 28.3" x 2.7"



TH-47LF6
140 W
Approx. 16.7 kg/36.9 lbs
1,076 x 621 x 68 mm/
42.4" x 24.5" x 2.7"



TH-42LF6
125 W
Approx. 14.5 kg/32.0 lbs
967 x 560 x 68 mm/
38.1" x 22.1" x 2.7"



LFV Series

Super Narrow Bezel
24/7 Use Reliability
Easy Installation & Connection



TH-55LFV50
320 W
Approx. 36.0 kg/79.3 lbs
1,216 x 687 x 122 mm/
47.9" x 27.1" x 4.8"



TH-55LFV5
220 W
Approx. 36.0 kg/79.3 lbs
1,216 x 687 x 122 mm/
47.9" x 27.1" x 4.8"



TH-47LFV5
160 W
Approx. 25.0 kg/55.1 lbs
1,045 x 590 x 109 mm/
41.2" x 23.3" x 4.3"



LFX Series

High Visibility Under Sunlight
Durability Against Rain/Dust
System Expandability



TH-47LFX60
370 W
Approx. 47.0 kg/103.0 lbs
1,162 x 706 x 216 mm/
46.8" x 27.8" x 8.5"



TH-47LFX6
370 W
Approx. 49.5 kg/109.1 lbs
1,162 x 706 x 216 mm/
45.8" x 27.8" x 8.5"



LFB Series

Easy set-up and Operation
Wireless & Network Capability
ECO & Good Usability



TH-80LFB70
Approx. 83.0 kg/183.0 lbs
1,868 x 1,093 x 104 mm/
73.6" x 43.1" x 4.1"



TH-65LFB70
(T.B.D.)
1,517 x 892 x 106 mm/
59.8" x 35.2" x 4.2"



TH-50LFB70
(T.B.D.)
1,185 x 705 x 103 mm/
46.7" x 27.8" x 4.1"



LFC Series

Bright Clear Image Quality
Wireless & Network Capability
Low Power Consumption

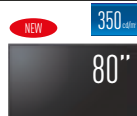

TH-80LFC70
(T.B.D.)



TH-65LFC70
(T.B.D.)
1,482 x 857 x 92 mm/
58.4" x 33.8" x 3.7"



TH-50LFC70
(T.B.D.)
1,149 x 669 x 89 mm/
45.3" x 26.4" x 3.5"



LFE Series

Slim & Stylish Design
High Picture Quality and Ecology
LAN & RS232C Control Capability

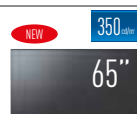

TH-65LFE7
Approx. 34.0 kg/75.0 lbs
1,458 x 840 x 52 mm/
57.4" x 33.1" x 2.1"

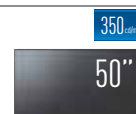

TH-50LFE6
90 W
Approx. 18.0 kg/39.7 lbs
1,121 x 655 x 49 mm/
44.2" x 25.8" x 2.0"

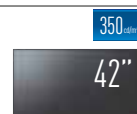

TH-42LFE6
65 W
Approx. 13.5 kg/29.8 lbs
957 x 564 x 49 mm/
36.6" x 22.2" x 2.0"





	Model no.	TH-80LF50ER	TH-70LF50ER		TH-55LF60W	TH-47LF60W	TH-42LF60W
DISPLAY	Screen Size (Diagonal)/Aspect Ratio	80-inch (2,032 mm)/16:9	70-inch (1,765 mm)/16:9		55-inch (1,387 mm)/16:9	47-inch (1,192 mm)/16:9	42-inch (1,067 mm)/16:9
	Panel Type	E-LED	E-LED		IPS/E-LED	IPS/E-LED	IPS/E-LED
	Effective Display Area (W x H)	1,771 x 996 mm	1,538 x 865 mm		1,209 x 680 mm	1,039 x 584 mm	930 x 523 mm
	Number of Pixels (H x V)	1,920 x 1,080 pixels	1,920 x 1,080 pixels		1,920 x 1,080 pixels	1,920 x 1,080 pixels	1,920 x 1,080 pixels
	Brightness	700 cd/m ² (Typ)	700 cd/m ² (Typ)		700 cd/m ² (Typ)	700 cd/m ² (Typ)	700 cd/m ² (Typ)
	Contrast Ratio	5,000:1	5,000:1		1,300:1	1,300:1	1,300:1
	Response Time	9 ms (G to G)	9 ms (G to G)		12 ms (G to G)	12 ms (G to G)	12 ms (G to G)
TERMINAL	Viewing Angle	178°/178°	178°/178°		178°/178°	178°/178°	178°/178°
	VIDEO In	BNC x 1			BNC x 1		
	Audio In (L/R)	Pin Jack x 1 set			Pin Jack x 1 set		
	HDMI In	HDMI Type A Connector x 1			HDMI Type A Connector x 2		
	Component/RGB In	BNC x 1 set			BNC x 1 set		
	Audio In (L/R)	Pin Jack x 1 set			Pin Jack x 1 set		
	DVI-D In	DVI-D 24-pin x 1			DVI-D 24-pin x 1		
	Audio In (L/R)	M3 Jack x 1 (Shared with PC In)			M3 Jack x 1 (Shared with PC In)		
	DVI-D Out	DVI-D 24-pin x 1			DVI-D 24-pin x 1		
	PC In	Mini D-Sub 15-pin x1 (Female)			Mini D-Sub 15-pin x 1 (Female)		
	Audio In (L/R)	M3 Jack x 1 (Shared with DVI-D In)			M3 Jack x 1 (Shared with DVI-D In)		
	Audio Out (L/R)	Pin Jack x 1 set			M3 Jack x 1		
	Serial In/Out	D-Sub 9-pin x 1/D-Sub 9-pin x 1, RS-232C Compatible			D-Sub 9-pin x 1/D-Sub 9-pin x 1, RS-232C Compatible		
	DIGITAL LINK	—			RJ45 x 1 (Shared with LAN)		
	LAN	RJ45 10BASE-T/100BASE-TX, Compatible with PLink™			RJ45 100BASE-TX, Compatible with PLink™ (Shared with DIGITAL LINK)		
GENERAL	IR In/Out	—			IR x 1/x 1		
	Function Slot	SLOT2.0 x 1			—		
	Power Requirements	220-240 V AC, 50 Hz/60 Hz	220-240 V AC, 50 Hz/60 Hz		220-240 V AC, 50 Hz/60 Hz	220-240 V AC, 50 Hz/60 Hz	220-240 V AC, 50 Hz/60 Hz
	Power Consumption	Approx. 380 W	Approx. 260 W		Approx. 150 W	Approx. 140 W	Approx. 125 W
	Power Off Condition	Approx. 0.3 W	Approx. 0.3 W		Approx. 0.3 W	Approx. 0.3 W	Approx. 0.3 W
	Stand-by Condition	Approx. 0.5 W	Approx. 0.5 W		Approx. 0.5 W	Approx. 0.5 W	Approx. 0.5 W
	Dimensions (W x H x D)	1,848 x 1,073 x 89 mm	1,604 x 931 x 89 mm		1,248 x 718 x 68 mm	1,076 x 621 x 68 mm	967 x 560 x 68 mm
	Carton Size (W x H x D)	1,993 x 1,188 x 349 mm	1,750 x 1,047 x 349 mm		1,411 x 940 x 204 mm	1,210 x 826 x 204 mm	1,113 x 705 x 222 mm
	Bezel Width	36 mm	30 mm		16 mm	16 mm	16 mm
	Weight	Approx. 60.0 kg	Approx. 47.0 kg		Approx. 25.8 kg	Approx. 16.7 kg	Approx. 14.5 kg
	Gross Weight	Approx. 71.0 kg	Approx. 56.0 kg		Approx. 31.5 kg	Approx. 21.8 kg	Approx. 18.5 kg
	Pitch for Wall-Hanging	VESA Compliant 400 mm x 400 mm	VESA Compliant 400 mm x 400 mm		VESA Compliant 400 mm x 400 mm	VESA Compliant 400 mm x 400 mm	VESA Compliant 400 mm x 400 mm
	Built-in Speakers	—			10 W [5W x 5 W]	10 W [5W + 5 W]	10 W [5W + 5 W]
OPTIONS	Operating Environment	Temperature: 0 °C to 40 °C / Humidity: 20 % to 80 % (Non Condensation)			Temperature: 0 °C to 40 °C / Humidity: 20 % to 80 % (Non Condensation)		
	Storage Environment	Temperature: -20 °C to 60 °C*1 / Humidity: 20 % to 80 % (Non Condensation)			Temperature: -20 °C to 60 °C / Humidity: 20 % to 80 % (Non Condensation)		
	Pedestal	TY-ST65P20	TY-ST58P20		TY-ST58P20	TY-ST42P50	TY-ST42P50
	Wall-hanging Bracket	TY-WK70PV50	TY-WK70PV50		—	—	—
	Protective Glass	TY-PG80LF50	TY-PG70LF50		—	—	—
	Digital Interface Box	—	—		ET-YFB100G	ET-YFB100G	ET-YFB100G
	HD-SDI Terminal Board	TY-FB10HD	TY-FB10HD		—	—	—
	Dual HDMI Terminal Board	TY-FB10HMD	TY-FB10HMD		—	—	—
	Slot in PC	PLUGTHA54	PLUGTHA54		—	—	—

*1: If the temperature is 40 °C to 60 °C, please keep in humidity 20 % to 40 %.



	Model no.	TH-55LF6W	TH-47LF6W	TH-42LF6W
DISPLAY	Screen Size (Diagonal)/Aspect Ratio	55-inch (1,387 mm)/16:9	47-inch (1,192 mm)/16:9	42-inch (1,067 mm)/16:9
	Panel Type	IPS/E-LED	IPS/E-LED	IPS/E-LED
	Effective Display Area (W x H)	1,209 x 680 mm	1,039x 584 mm	930 x 523 mm
	Number of Pixels (H x V)	1,920 x 1,080 pixels	1,920 x 1,080 pixels	1,920 x 1,080 pixels
	Brightness	450 cd/m ² (Typ)	450 cd/m ² (Typ)	450 cd/m ² (Typ)
	Contrast Ratio	1,300:1	1,300:1	1,300:1
	Response Time	12 ms (G to G)	12 ms (G to G)	12 ms (G to G)
TERMINAL	Viewing Angle	178°/178°	178°/178°	178°/178°
	VIDEO In	BNC x 1		BNC x 1
	Audio In (L/R)	Pin Jack x 1 set		Pin Jack x 1 set
	HDMI In	HDMI Type A Connector x 2		HDMI Type A Connector x 2
	Component In	BNC x 1 set		BNC x 1 set
	Audio In (L/R)	Pin Jack x 1 set		Pin Jack x 1 set
	DVI-D In	DVI-D 24-pin x 1		DVI-D 24-pin x 1
	Audio In (L/R)	M3 Jack x 1 (Shared with PC In)		M3 Jack x 1 (Shared with PC In)
	DVI-D Out	DVI-D 24-pin x 1		DVI-D 24-pin x 1
	PC In	Mini D-Sub 15-pin x1 (Female)		Mini D-Sub 15-pin x1 (Female)
	Audio In (L/R)	M3 Jack x 1 (Shared with DVI-D In)		M3 Jack x 1 (Shared with DVI-D In)
	Audio Out (L/R)	M3 Jack x 1		M3 Jack x 1
	Serial In/Out	D-Sub 9-pin x 1/D-Sub 9-pin x 1, RS-232C Compatible		D-Sub 9-pin x 1/D-Sub 9-pin x 1, RS-232C Compatible
	DIGITAL LINK	RJ45 x 1 (Shared with LAN)		RJ45 x 1 (Shared with LAN)
	LAN	RJ45 100BASE-TX, Compatible with PULink™ (Shared with DIGITAL LINK)		RJ45 100BASE-TX, Compatible with PULink™ (Shared with DIGITAL LINK)
	IR In/Out	IR x 1/x 1		IR x 1/x 1
	Function Slot	—		—
GENERAL	Power Requirements	220-240 V AC, 50 Hz/60 Hz	220-240 V AC, 50 Hz/60 Hz	220-240 V AC, 50 Hz/60 Hz
	Power Consumption	Approx. 150 W	Approx. 140 W	Approx. 125 W
	Power Off Condition	Approx. 0.3 W	Approx. 0.3 W	Approx. 0.3 W
	Stand-by Condition	Approx. 0.5 W	Approx. 0.5 W	Approx. 0.5 W
	Dimensions (W x H x D)	1,248 x 718 x 68 mm	1,076 x 621 x 68 mm	967 x 560 x 68 mm
	Carton Size (W x H x D)	1,411 x 940 x 204 mm	1,210 x 826 x 204 mm	1,113 x 705 x 222 mm
	Bezel Width	16 mm	16 mm	16 mm
	Weight	Approx. 25.8 kg	Approx. 16.7 kg	Approx. 14.5 kg
	Gross Weight	Approx. 31.5 kg	Approx. 21.8 kg	Approx. 18.5 kg
	Pitch for Wall-Hanging	VESA Compliant 400 mm x 400 mm	VESA Compliant 400 mm x 400 mm	VESA Compliant 400 mm x 400 mm
	Built-in Speakers	10 W [5W x 5 W]	10 W [5W + 5 W]	10 W [5W + 5 W]
	Operating Environment	Temperature: 0 °C to 40 °C / Humidity: 20 % to 80 % (Non Condensation)		Temperature: 0 °C to 40 °C / Humidity: 20 % to 80 % (Non Condensation)
OPTIONS	Storage Environment	Temperature: -20 °C to 60 °C / Humidity: 20 % to 80 % (Non Condensation)		Temperature: -20 °C to 60 °C / Humidity: 20 % to 80 % (Non Condensation)
	Pedestal	TY-ST58P20	TY-ST42P50	TY-ST42P50
	Digital Interface Box	ET-YFB100G	ET-YFB100G	ET-YFB100G

Bright, Full HD (1920 x 1080) Professional LED Display

LF50 LF60 LF6

In addition to the high resolution of Full-HD and the wide viewing angle of the IPS panel, the LF Series features high brightness. This makes it possible to display crisp, clear images even in bright places, for signage with excellent information transmission performance.



IPS Panel and LED Backlight Provide Light Weight, a Thin Profile, and Low Power Consumption

LF60 LF6

Detailed Full-HD picture quality and the wide viewing angle of the IPS panel produce clear, beautiful images in large spaces. The use of an LED backlight allows signage to be used for long periods with excellent visibility and low power consumption, to help reduce running costs.

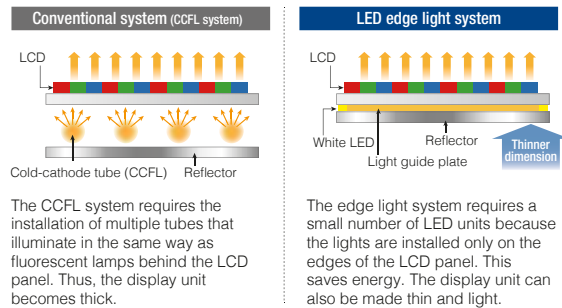

Flexible, Vertical Installation

LF50 LF60 LF6

The display can be installed either horizontally or vertically to match the content and installation location without being affected by "Mura" (unevenness). This is because the display has relatively uniform pressure distribution as compared to a TV panel, which results in far better stability. Regardless of the installation direction, the lamp life stays the same since a constant operating temperature is maintained.



DIGITAL LINK Function Enables Simple Installation and Low System Costs

LF60 LF6

Using DIGITAL LINK makes it possible to transmit video, audio and control signals over a long distance (up to 100 m) with a single LAN cable*. Easy cabling also reduces labor during setup. This provides transmission of high-quality images and sounds, as well as remote control.

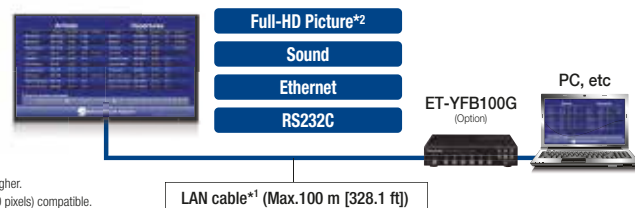

*1: CAT5e (STP) cable or higher.
*2: WUXGA (1,920 x 1,200 pixels) compatible.

24/7 Operation

LF50 LF60 LF6

The tough design makes the display panel suitable for use as signage that operates all day and night in places such as restaurants, shopping malls and transportation facilities.



* In case of long time, the moving image is recommended to be displayed. If you display a still picture for an extended period, the image retention might remain on the screen. However, image retention can gradually disappear by displaying a moving images.

Fan-less Design

LF50 LF60 LF6

The fan-less design prevents malfunctions otherwise caused by dust particles brought in by the fan. This enables safe installation in crowded areas.

Built-in Speaker

LF60 LF6

The speaker is built into the rear of the display. There is no need for external speakers when using content that has a soundtrack.



Stylish Slim Design and Light Weight

LF50 LF60 LF6

Narrow bezel allows it to blend in with the installation space and gives greater visibility to the images on display. The bezel is also less noticeable in multi-screen displays, for effective large-screen applications.

A Slim Design that Fits almost any Installation Location

LF50 LF60 LF6

The display can be installed in a permanent hanging position using eyebolts. Wall-mount brackets and hanging fixtures in compliance with VESA specifications can also be used for flexible installation.

* 55-inch only.



Full Power Plug-In PC for SLOT2.0 Platform

LF50

The new, full power Plug-in PC solution that supports virtually all digital signage software platforms with multiple zones of content. The PLUGTHA54 Plug-In PC combines a fully contained "all-in-one" digital signage solution with the ease and flexibility of Panasonic SLOT2.0 plug-in architecture. The PLUGTHA54 can run the most robust digital signage applications and high-quality graphics 24/7/365 with superior reliability and low failure rates for a lower TCO.



- Intel® i5 Processor
- Windows® 7 pro (64bit)
- 320 GB HDD
- Built-in Wi-Fi and RJ-45
- 3G/4G Ready for 24/7/365 digital signage solution



	Model no.	TH-55LFV50W	TH-55LFV5W	TH-47LFV5W
DISPLAY	Screen Size (Diagonal)/Aspect Ratio	55-inch (1,387.8 mm)/16:9	55-inch (1,387.8 mm)/16:9	47-inch (1,192 mm)/16:9
	Panel Type	IPS/D-LED	IPS/D-LED	IPS/D-LED
	Effective Display Area (W x H)	1,290 x 680 mm	1,290 x 680 mm	1,039 x 584 mm
	Number of Pixels (H x V)	1,920 x 1,080 pixels	1,920 x 1,080 pixels	1,920 x 1,080 pixels
	Brightness	800 cd/m ² (Typ)	500 cd/m ² (Typ)	500 cd/m ² (Typ)
	Contrast Ratio	1,400:1	1,400:1	1,400:1
	Response Time	10 ms (G to G)	10 ms (G to G)	12 ms (G to G)
	Viewing Angle	178°/178°	178°/178°	178°/178°
	Panel Surface Treatment	Anti-Reflection	Anti-Glare Treatment (Haze 10 %)	Anti-Glare Treatment (Haze 10 %)
TERMINAL	VIDEO In	BNC x 1	BNC x 1	BNC x 1
	Audio In (L/R)	Pin Jack x 1 set (Shared with Component In)	Pin Jack x 1 set (Shared with Component In)	Pin Jack x 1 set (Shared with Component In)
	HDMI In	HDMI Type A Connector x 1	HDMI Type A Connector x 1	HDMI Type A Connector x 1
	Component/RGB In	BNC x 1 set	BNC x 1 set	BNC x 1 set
	Audio In (L/R)	Pin Jack x 1 set (Shared with VIDEO In)	Pin Jack x 1 set (Shared with VIDEO In)	Pin Jack x 1 set (Shared with VIDEO In)
	DVI-D In	DVI-D 24-pin x 1	DVI-D 24-pin x 1	DVI-D 24-pin x 1
	Audio In (L/R)	M3 Jack x 1 (Shared with PC In)	M3 Jack x 1 (Shared with PC In)	M3 Jack x 1 (Shared with PC In)
	DVI-I Out	DVI-I 29-pin x 1	DVI-I 29-pin x 1	DVI-I 29-pin x 1
	PC In	Mini D-Sub 15-pin x1 (Female)	Mini D-Sub 15-pin x1 (Female)	Mini D-Sub 15-pin x1 (Female)
	Audio In (L/R)	M3 Jack x 1 (Shared with DVI-D In)	M3 Jack x 1 (Shared with DVI-D In)	M3 Jack x 1 (Shared with DVI-D In)
	Audio Out (L/R)	Pin Jack x 1 set	Pin Jack x 1 set	Pin Jack x 1 set
GENERAL	Serial In/Out	D-Sub 9-pin x 1/D-Sub 9-pin x 1, RS-232C Compatible	D-Sub 9-pin x 1/D-Sub 9-pin x 1, RS-232C Compatible	D-Sub 9-pin x 1/D-Sub 9-pin x 1, RS-232C Compatible
	Function Slot	—	—	—
	IR Transmitter In/Out	IR x 1/x 1	IR x 1/x 1	IR x 1/x 1
	LAN	RJ45 x 1 (Web Browser Control Only)	RJ45 x 1 (Web Browser Control Only)	RJ45 x 1 (Web Browser Control Only)
	Power Requirements	220-240 V AC, 50 Hz/60 Hz	220-240 V AC, 50 Hz/60 Hz	220-240 V AC, 50 Hz/60 Hz
	Power Consumption	320 W	220 W	160 W
	Stand-by Condition	Approx. 0.5 W	Approx. 0.5 W	Approx. 0.5 W
	Dimensions (W x H x D)	1215.5 x 686.3 x 121.2 mm	1215.5 x 686.3 x 121.2 mm	1,045 x 590 x 109 mm
	Carton Size (W x H x D)	1,551 x 979 x 450 mm	1,551 x 979 x 450 mm	1,420 x 995 x 514 mm
	Bezel Width	3.4 mm (Left/Top), 1.9 mm (Right/Bottom)	3.4 mm (Left/Top), 1.9 mm (Right/Bottom)	3.2mm (Left/Top), 1.7 mm (Right/Bottom)
	Bezel to Bezel	5.3 mm (Multi Screen)	5.3 mm (Multi Screen)	4.9 mm (Multi Screen)
OPTIONS	Weight	Approx. 36.0 kg	Approx. 36.0 kg	Approx. 25.0 kg
	Gross Weight	Approx. 48.0 kg	Approx. 52.0 kg	Approx. 40.0 kg
	Pitch for Wall-Hanging	VESA Compliant 400 mm x 400 mm	VESA Compliant 400 mm x 400 mm	VESA Compliant 400 mm x 400 mm
	External Speaker	8Ω, 20 W [10 W + 10 W]	8Ω, 20 W [10 W + 10 W]	Speaker Out: 8Ω, 20 W [10 W + 10 W]
	Operating Environment	Temperature: 0 °C to 40 °C / Humidity: 10 % to 90 % (Non Condensation)		
	Storage Environment	Temperature: -20 °C to 60 °C / Humidity: 10 % to 90 % (Non Condensation)		
		Remote Control Kit	TY-RM50WW	TY-RM50WW
		Cover Frame Kit	TY-CF55VW50	TY-CF47VW5
		Multi Window Processor	ET-WMP100G	ET-WMP100G

**Super Narrow Bezel
with 4.9-mm* Thinness**

The super-narrow bezel results in joints that are only 4.9 mm wide for video wall installations. Even in large-screen configurations, the screen borders can barely be seen, so images are powerful and natural.



* The 55-inch model is 5.3 mm wide.

**Reduce reflection of external light,
Anti-Glare (AG) treatment Panel**

The AG layer of LFV5 Series scatters light reflected from the sun or illumination to reduce glare. This provides greater visibility. It is ideal for use in surveillance stations and public facilities.

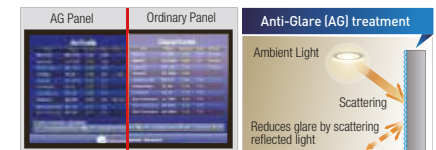

High Reliability Enables Continuous 24-Hour Operation

The use of a highly durable panel and electronic components allows continuous 24-hour operation, ideal for installation in public places, surveillance stations, etc. A built-in cooling fan automatically operates (when set to Auto) depending on the temperature. This prevents overheating in the upper screens of a multi-screen installation, which are easily subject to heating.



* In case of long time, the moving image is recommended to be displayed. If you display a still picture for an extended period, the image retention might remain on the screen. However, image retention can gradually disappear by displaying a moving images.

		LED	CCFL
		47"	47"
		TH-47LFX60W	TH-47LFX6W
DISPLAY	Model no.	TH-47LFX60W	TH-47LFX6W
	Screen Size (Diagonal)/Aspect Ratio	47-inch (1,192 mm)/16:9	47-inch (1,192 mm)/16:9
	Panel Type	IPS/D-LED	IPS/CCFL
	Effective Display Area (W x H)	1,039 x 584 mm	1,039 x 584 mm
	Number of Pixels (H x V)	1,920 x 1,080 pixels	1,920 x 1,080 pixels
	Brightness	2,000 cd/m ² (Typ)	1,000cd/m ² (Typ)
	Contrast Ratio	1,300:1	1,200:1
TERMINAL	Response Time	10 ms (G to G)	—
	Viewing Angle	178°/178°	178°/178°
	VIDEO In	—	—
	Audio In (L/R)	—	—
	HDMI In	HDMI Type A Connector x 1	—
	Component/RGB In	—	—
	Audio In (L/R)	—	—
GENERAL	DVI-D In	DVI-D 24-pin x 1	—
	Audio In (L/R)	M3 Jack x 1 (Shared with PC In)	—
	PC In	Mini D-Sub 15-pin x1 (Female)	—
	Audio In (L/R)	M3 Jack x 1 (Shared with DVI-D In)	—
	Audio Out (L/R)	Pin Jack x 1 set	—
	DIGITAL LINK	RJ45 x 1 (Shared with LAN)	—
	Serial In	D-Sub 9-pin x 1, RS-232C Compatible	—
OPTIONS	LAN	RJ45 x 1 100BASE-TX, Compatible with PLink™ (Shared with DIGITAL LINK)	—
	Power Requirements	220-240 V AC, 50 Hz/60 Hz	220-240 V AC, 50 Hz/60 Hz
	Power Consumption	370 W	370 W
	Power Off Condition	Approx. 0.3 W	Approx. 0.3 W
	Stand-by Condition	Approx. 0.5 W	Approx. 0.5 W
	Outdoor Mode On	Approx. 41 W	Approx. 41 W
	Network Stand-by Mode	Approx. 16 W	Approx. 16 W
GENERAL	Dimensions (W x H x D)	1,162 x 706 x 216 mm	1,162 x 706 x 216 mm
	Carton Size (W x H x D)	1,308 x 851 x 323 mm	1,308 x 851 x 323 mm
	Bezel Width	32 mm	32 mm
	Weight	Approx. 47.0 kg	Approx. 49.5 kg
	Gross Weight	Approx. 55.0 kg	Approx. 58.0 kg
	Pitch for Wall-Hanging	VESA Compliant 400 mm x 400 mm	VESA Compliant 400 mm x 400 mm
	Built-in Speakers	—	—
GENERAL	Direct Sunlight Capability	Yes (Built-in Air Cooling System)	Yes (Built-in Air Cooling System)
	Dust and Water Resistant Level	IP55	IP44
	Operating Environment*1	Temperature: -20 °C*2 to 50 °C / Humidity: 20 % to 80 % (Non Condensation)	Temperature: -20 °C*2 to 40 °C / Humidity: 20 % to 80 % (Non Condensation)
	Storage Environment	Temperature: -20 °C to 60 °C / Humidity: 20 % to 80 % (Non Condensation)	Temperature: -20 °C to 60 °C / Humidity: 20 % to 80 % (Non Condensation)
	Replacement Air Filter	TY-AF60STD	TY-AF6STD
	Digital Interface Box	ET-YFB100G	ET-YFB100G
	Early Warning Software	ET-SWA100	—

*1: Don't use in places where the presence of corrosive gases or salt damage area.
*2: When used in Outdoor mode.

Dust and Water Resistance Performance – Ideal for Outdoor Installation

IP level dust and water resistant performance provides tough durability in harsh conditions.

* What is IP?: This denotes the degree of dust and water resistance. IP is an abbreviation of the international standard Ingress Protection. (IEC60529)

LFX60 IP-55		LFX6 IP-44	
Dust Resistance		Water Resistance	
Level	Degree of Protection	Level	Degree of Protection
5	Protected against dust limited ingress (no harmful deposit)	5	Protected against water jet.
4	Protection from solid bodies greater than 1 mm in diameter	4	Protection of the display from water splashing (in both vertical and horizontal directions)

High-Brightness 2,000-cd/m² Model with Wide-Viewing-Angle IPS Panel and LED Backlight

Images are clear even in brightly lit places. Full 2,000 cd/m²* brightness maintains excellent visibility under direct sunlight. This makes the LFX ideal for installation in drive-through lanes. And because the brightness isn't affected by external light, information such as menu items and prices remain clear and easy to read.



* The LFX60 only. The LFX6 has 1,000 cd/m² of brightness.

Forced Air-Cooling System Helps to Prevent Blackouts and Dew Condensation

Outside air is brought into the cabinet to produce an airflow between the front glass and the LCD panel. This suppresses internal temperature rises and prevents blackouts when the display is installed outdoors. It also serves as a countermeasure against condensation.

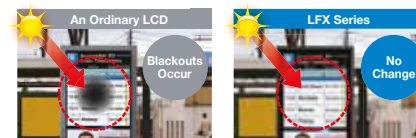

Direct sunlight raises the LCD panel temperature and causes blackouts.

The LFX operates stably even outdoors under direct sunlight.

DIGITAL LINK for Transmission of Video, Audio and Control Signals for up to 100 m with a Single LAN Cable

Only a single LAN cable*1 is required to transmit uncompressed HD video, audio and control signals for a distance of up to 100 m. This enables indoor installation of the PC and other devices connected to the display at an outdoor location in order to protect the PC and devices from rain and dust. Since only one cable needs to be connected between the PC and panel, cable routing work is quick and easy. Because a control signal can also be sent simultaneously, it is easy to upgrade the system by combining it with the optional ET-YFB100G Digital Interface Box.

*1: Use an STP cable of CAT5e or higher.
*2: WUXGA (1,920 x 1,200 pixels) compatible.

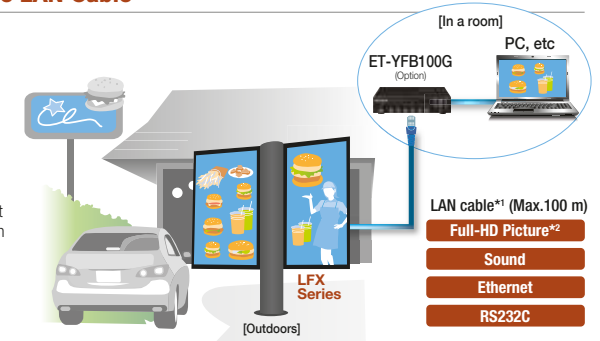

Aluminum Cabinet and Tempered Glass

The aluminum cabinet strongly resists corrosion. In addition, tempered glass ensures rugged strength against impacts.

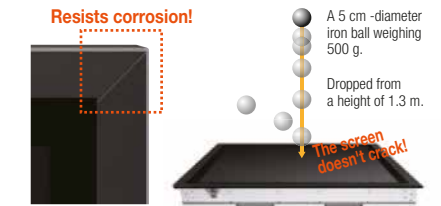

Highly Durable Display Resists Temperature Changes and the Summer Sun

Featuring an operating temperature range of -20 °C*1 to 50 °C*2, performance remains unchanged even in cold and hot climates.

*1: When used in Outdoor mode.

*2: The LFX60 range is up to 50 °C, and the LFX6 range is up to 40 °C.

Supporting Stable Operation — Early Warning Software

Early Warning Software monitors the status of display connected to an intranet and informs you when an abnormality is detected or predicted, and when there are symptoms of trouble. The minimizes display downtime to support more stable operation.

* The LFX60 only.

<div> <div>LED</div> <div>80"</div> <div>LED</div> <div>65"</div> <div>LED</div> <div>50"</div> </div>				
Model no.	TH-80LFB70E	TH-65LFB70E		TH-50LFB70E
DISPLAY	Screen Size (Diagonal)/Aspect Ratio	80-inch (2,032 mm)/16:9	65-inch (1,638 mm)/16:9	50-inch (1,257 mm)/16:9
	Panel Type	E-LED	E-LED	E-LED
	Effective Display Area (W x H)	1,771 x 996 mm	1,428 x 803 mm	1,095 x 616 mm
	Number of Pixels (H x V)	1,920 x 1,080 pixels	1,920 x 1,080 pixels	1,920 x 1,080 pixels
	Brightness	350 cd/m ² (Typ)	350 cd/m ² (Typ)	350 cd/m ² (Typ)
	Contrast Ratio	5,000:1	4,000:1	5,000:1
	Response Time	4 ms (G to G)	6.5 ms (G to G)	6.5 ms (G to G)
	Viewing Angle	176°/176°	178°/178°	176°/176°
TOUCH PANEL	Detection Method	Infrared Blocking Detection Method	Infrared Blocking Detection Method	Infrared Blocking Detection Method
	PC Connection Port	USB (3.0 Compliant)	USB (3.0 Compliant)	USB (3.0 Compliant)
	Protective Glass Thickness	Approx. 4 mm /Anti-Glare	Approx. 3.2 mm /Anti-Glare	Approx. 2.5 mm /Anti-Glare
TERMINAL	VIDEO In	BNC x 1		BNC x 1
	Audio In (L/R)	M3 Jack x 1 (Shared with Component/RGB In)		M3 Jack x 1 (Shared with Component/RGB In)
	HDMI In	HDMI Type A Connector x 2		HDMI Type A Connector x 2
	Component/RGB In	BNC x 1 set		BNC x 1 set
	Audio In (L/R)	M3 Jack x 1 (Shared with VIDEO In)		M3 Jack x 1 (Shared with VIDEO In)
	DVI-D In	DVI-D 24-pin x 1		DVI-D 24-pin x 1
	Audio In (L/R)	M3 Jack x 1 (Shared with PC In)		M3 Jack x 1 (Shared with PC In)
	PC In	Mini D-Sub 15-pin x1 (Female), Plug & Play (VESA DDC 2B)		Mini D-Sub 15-pin x1 (Female), Plug & Play (VESA DDC 2B)
	Audio In (L/R)	M3 Jack x 1 (Shared with DVI-D In)		M3 Jack x 1 (Shared with DVI-D In)
	PC Out	Mini D-Sub 15-pin x1		Mini D-Sub 15-pin x1
	External Speaker	8 Ω, 20 W [10 W + 10 W] (10 % THD)		T.B.D.
	USB A	TYPE A USB Connector x 1 (For Memory Viewer)		TYPE A USB Connector x 1 (For Memory Viewer)
	USB B	TYPE B USB Connector x 1 (For Touch Panel)		TYPE B USB Connector x 1 (For Touch Panel)
	Serial	D-Sub 9-pin x 1, RS-232C Compatible		D-Sub 9-pin x 1, RS-232C Compatible
	DIGITAL LINK	RJ45 x 1 (Shared with LAN)		RJ45 x 1 (Shared with LAN)
GENERAL	LAN	RJ45 x 1, 100BASE-TX, Compatible with PLink™ (Shared with DIGITAL LINK)		RJ45 x 1, 100BASE-TX, Compatible with PLink™ (Shared with DIGITAL LINK)
	Function Slot	SLOT2.0 x 1		SLOT2.0 x 1
	Power Requirements	220-240 V AC, 50/60 Hz		220-240 V AC, 50/60 Hz
	Power Consumption	350 W		T.B.D.
	Power Off Consumption	Approx. 0.3 W		Approx. 0.3 W
	Stand-by Condition	Approx. 0.5 W		Approx. 0.5 W
	Dimensions (W x H x D)	1,868 x 1,093 x 104 mm		1,185 x 705 x 103 mm (T.B.D.)
	Carton Size (W x H x D)	2,075 x 1,319 x 404 mm		T.B.D.
	Bezel Width	43 mm		39 mm
	Weight	Approx. 83.0 kg		T.B.D.
	Gross Weight	Approx. 103.0 kg		T.B.D.
	Pitch for Wall-Hanging	VESA Compliant 400 x 400 mm		400 x 300 mm
	Built-in Speaker	20 W [10 W + 10 W]		20 W [10 W + 10 W]
	Operating Environment	Temperature: 0 °C to 40 °C, Humidity: 20 % to 80 % (Non Condensation)		Temperature: 0 °C to 40 °C, Humidity: 20 % to 80 % (Non Condensation)
	Storage Environment*1	Temperature: -20 °C to 60 °C, Humidity: 20 % to 80 % (Non Condensation)		Temperature: -20 °C to 60 °C, Humidity: 20 % to 80 % (Non Condensation)
OPTIONS	Pedestal	TY-ST65P20		TY-ST42P50
	Wall-hanging Bracket	TY-WK70PV50 (Vertical)		TY-WK42PV20 (Vertical)
	Wall-hanging Bracket (Angled)	—		TY-WK42PR20 (Angled)
	Ceiling-hanging Bracket	—		TY-CE42PS20
	Mobile Stand	TY-ST80LF70		TY-ST50PB2/TY-ST58PF20
	Easy Wireless Stick	ET-UW100		ET-UW100
FUNCTION BOARD	Digital Interface Box	ET-YFB100G		ET-YFB100G
	HD-SDI Terminal Board	TY-FB9HD		TY-FB9HD
	HD-SDI Terminal Board with Audio	TY-FB10HD		TY-FB10HD
	Dual Link HD-SDI Terminal Board	TY-FB11DHD		TY-FB11DHD
	Dual HDMI Terminal Board	TY-FB10HMD		TY-FB10HMD
	BNC Dual Video Terminal Board	TY-FB9BD		TY-FB9BD
	DVI-D Terminal Board	TY-FB11DD		TY-FB11DD
	Plug in PC	PLUGTHA54		PLUGTHA54

<div> <div>LED</div> <div>80"</div> <div>LED</div> <div>65"</div> <div>LED</div> <div>50"</div> </div>				
Model no.	TH-80LFC70E	TH-65LFC70E		TH-50LFC70E
DISPLAY	Screen Size (Diagonal)/Aspect Ratio	80-inch (2,032 mm)/ 16:9	65-inch (1,638 mm)/16:9	50-inch (1,257 mm)/16:9
	Panel Type	E-LED	E-LED	E-LED
	Effective Display Area (W x H)	1,771 x 996 mm	1,428 x 803 mm	1,095 x 616 mm
	Number of Pixels (H x V)	1,920 x 1,080 pixels	1,920 x 1,080 pixels	1,920 x 1,080 pixels
	Brightness	350 cd/m ² (Typ)	350 cd/m ² (Typ)	350 cd/m ² (Typ)
	Contrast Ratio	5,000:1	4,000:1	5,000:1
	Response Time	4 ms (G to G)	6.5 ms (G to G)	6.5 ms (G to G)
	Viewing Angle	176°/176°	178°/178°	176°/176°
TERMINAL	VIDEO In	BNC x 1		BNC x 1
	Audio In (L/R)	M3 Jack x 1 (Shared with Component/RGB In)		M3 Jack x 1 (Shared with Component/RGB In)
	HDMI In	HDMI Type A Connector x 2		HDMI Type A Connector x 2
	Component/RGB In	BNC x 1 set		BNC x 1 set
	Audio In (L/R)	M3 Jack x 1 (Shared with VIDEO In)		M3 Jack x 1 (Shared with VIDEO In)
	DVI-D In	DVI-D 24-pin x 1		DVI-D 24-pin x 1
	Audio In (L/R)	M3 Jack x 1 (Shared with PC In)		M3 Jack x 1 (Shared with PC In)
	PC In	Mini D-Sub 15-pin x1 (Female), Plug & Play (VESA DDC 2B)		Mini D-Sub 15-pin x1 (Female), Plug & Play (VESA DDC 2B)
	Audio In (L/R)	M3 Jack x 1 (Shared with DVI-D In)		M3 Jack x 1 (Shared with DVI-D In)
	PC Out	Mini D-Sub 15-pin x 1		Mini D-Sub 15-pin x1
	External Speaker	8 Ω, 20 W [10 W + 10 W] (10 % THD)		T.B.D.
	USB	TYPE A USB Connector x 1 (For Memory Viewer)		TYPE A USB Connector x 1 (For Memory Viewer)
	Serial	D-Sub 9-pin x 1, RS-232C Compatible		D-Sub 9-pin x 1, RS-232C Compatible
	DIGITAL LINK	RJ45 x 1 (Shared with LAN)		RJ45 x 1 (Shared with LAN)
GENERAL	LAN	RJ45 x 1, 100BASE-TX, Compatible with PLink™ (Shared with DIGITAL LINK)		RJ45 x 1, 100BASE-TX, Compatible with PLink™ (Shared with DIGITAL LINK)
	Function Slot	SLOT2.0 x 1		SLOT2.0 x 1
	Power Requirements	220-240 V AC, 50/60 Hz		220-240 V AC, 50/60 Hz
	Power Consumption	T.B.D.		T.B.D.
	Power off Consumption	T.B.D.		T.B.D.
	Stand-by Condition	T.B.D.		T.B.D.
	Dimensions (W x H x D)	T.B.D.		1,149 x 669 x 89 mm (T.B.D.)
	Carton Size	T.B.D.		T.B.D.
	Bezel Width	T.B.D.		T.B.D.
	Weight	T.B.D.		T.B.D.
	Gross Weight	T.B.D.		T.B.D.
	Pitch for Wall-Hanging	VESA Compliant 400 x 400 mm		400 x 300 mm
	Built-in Speaker	20 W [10 W + 10 W]		20 W [10 W + 10 W]
	Operating Environment	Temperature: 0 °C to 40 °C, Humidity: 20 % to 80 % (Non Condensation)		Temperature: 0 °C to 40 °C, Humidity: 20 % to 80 % (Non Condensation)
	Storage Environment	Temperature: -20 °C to 60 °C, Humidity: 20 % to 80 % (Non Condensation)		Temperature: -20 °C to 60 °C, Humidity: 20 % to 80 % (Non Condensation)
OPTIONS	Pedestal	TY-ST65P20		TY-ST42P50
	Wall-hanging Bracket	TY-WK70PV50 (Vertical)		TY-WK42PV20 (Vertical)
	Wall-hanging Bracket (Angled)	—		TY-WK42PR20 (Angled)
	Ceiling-hanging Bracket	—		TY-CE42PS20
	Floor Stand	—		—
	Mobile Stand	TY-ST80LF70		TY-ST50PB2/TY-ST58PF20
	Easy Wireless Stick	ET-UW100		ET-UW100
FUNCTION BOARD	Digital Interface Box	ET-YFB100G		ET-YFB100G
	HD-SDI Terminal Board	TY-FB9HD		TY-FB9HD
	HD-SDI Terminal Board with Audio	TY-FB10HD		TY-FB10HD
	Dual Link HD-SDI Terminal Board	TY-FB11DHD		TY-FB11DHD
	Dual HDMI Terminal Board	TY-FB10HMD		TY-FB10HMD
	BNC Dual Video Terminal Board	TY-FB9BD		TY-FB9BD
	DVI-D Terminal Board	TY-FB11DD		TY-FB11DD
FUNCTION BOARD	Plug in PC	PLUGTHA54		PLUGTHA54

Multi Touch Screen LED Displays LFB70 Series/ Network LED Displays LFC70 Series



Simple Touch Control

LFB70

Progress smoothly through your presentation using familiar touch screen gestures to turn pages, zoom in/out content, and navigate through multimedia functions without need of a remote control. Whether using a fingertip to cue content for a presentation, or the stylus pen to jot down notes for the group, you'll be delighted at how this user-friendly touch interface makes complex tasks simple.



Work Together On Screen

LFB70

Built-in whiteboard software lets you turn on the display and start work right away — no need to connect a PC. Up to four people can write at a time, and you can save your pages and email them directly to anyone who missed the meeting. Notes can be made on almost anything, from video and photos to PowerPoint® and PDF documents, and then saved as an image file — simply brilliant for the office or classroom.

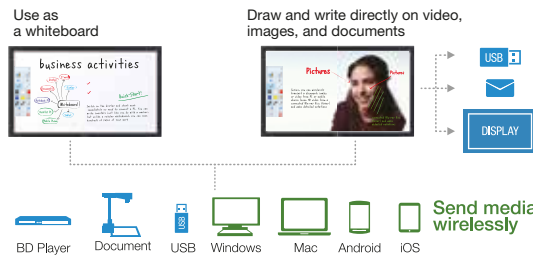

Note: Use of this product shall be in compliance with all relevant and applicable copyright protection laws. Data or work entered by the user into the Product's external inputs (including but not limited to motion pictures and photography) shall be the creation of the user (excluding quoting) or shall be authorized for use by the author(s) of the data or work. Panasonic has no right or authority to grant the Product user any license, rights, and titles to use, modify, copy, or distribute, etc., any data or work not created by the user or used with express permission of the data or work's author(s).

Whiteboard Software Extends Your Capabilities

LFB70

Whiteboard Software*1 for PC offers extra functionality for power users. As well as adding useful tools to the menu palette, the applications six-point touch interface*2 enables a wider variety of gestures for smooth and intuitive control.

- Three operation modes*2 (Whiteboard Function, PowerPoint® Link Mode, and Desktop Operation)
- Recorder function*2
- Image capture
- File operation (import and save)
- Presentation tool*2 (zoom, spotlight, shade, fade-out marker)

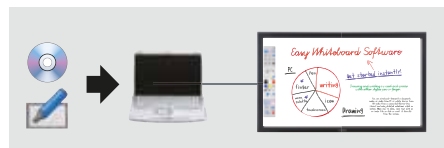

(Windows Version)

Wireless Options for Mobile and PC

LFB70 LFC70

It's simple to get documents from different network-attached devices — such as notebooks, smartphones, and tablet — onto the big screen. These pro displays are compatible with Miracast™ (which doesn't require any software to mirror certain content) as well as dedicated apps that get the media you want up and on screen faster, with no cables or complicated setup.

Miracast™ for Instant Wireless Sharing

Transmit documents, Full HD video, images, and audio from compatible Android devices and Windows PCs to the big screen with Miracast™ — the latest wireless standard that doesn't require software or complicated setup. With no cables, fast connection, and high bandwidth, Miracast™ makes it easy for everyone to contribute.



Wireless Apps for iOS and PC*3

A free iOS app conveniently displays content from iPod touch®, iPhone®, and iPad®, on the big screen, with no cables and no hassle. For PC users, Wireless Manager ME*4 wirelessly transmits a variety of media (including audio*5) from your computer to the display. It includes a Multi-Live mode to facilitate the display of content from up to 16PC or iOS devices simultaneously. Alternatively, you can plug an Easy Wireless Stick (ET-UW100)*6 into your computer's USB port to send content wirelessly*7.



Better Connectivity and Flexibility

LFB70 LFC70

With Panasonic's DIGITAL LINK, based on HDBaseT™ technology, and SLOT2.0 (which allows for easy installation and removal of customized terminal boards or a modular PC), it costs less money and time to set up the display exactly to your requirements.

DIGITAL LINK

DIGITAL LINK used HDBaseT™ technology to transmit uncompressed FULL HD video, audio, and control commands through a single CAT5 cable for up to 100 m (328 ft)

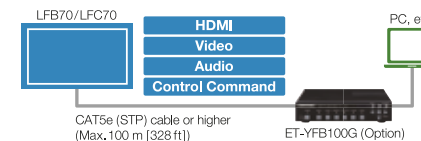

SLOT2.0

SLOT2.0 allows you to add the functions your need to perfectly suite almost any application. Optional function boards including HDMI, HD-SDI, and Plug-in PC can be mounted to support a customized content distribution system.



Easily Connect a Second Display

Use a VGA cable to mirror*8 content on a second display or projector — even the notes added to documents, images, or video during your presentation. This dual-display capability makes both the LFB70 and LFC70 Series ideal for use in larger venues.



*1: Supported by Windows® XP/Windows Vista® /Windows® 7/Windows® 8/Windows® 8.1 and Macintosh (Mac OS X v10.6/v10.7/v10.8/v10.9). Some functions are not supported on Macintosh version.

*2: For Windows only.

*3: Wireless display with devices that are not Miracast™-compatible or wireless display from multiple devices requires the installation of dedicated software.

*4: Supported by Windows® XP/Windows Vista® /Windows® 7/Windows® 8/Windows® 8.1 and Macintosh (Mac OS X v10.6/v10.7/v10.8/v10.9).

*5: Windows® 7 and Windows Vista® users must log in using the Administrator's account. When a Windows® 7 – equipped computer is first used, the sound driver may require adjustment.

*6: The ET-UW100 is available in the following countries and regions as of October 2013: North America, England, Germany, France, Spain, Italy, Belgium, Austria, Sweden, Norway, Denmark, Switzerland, Holland, Finland, Portugal, Greece, Australia, and Japan.

*7: The ET-UW100 will not transfer audio files. A firmware update is necessary to use the ET-UW100.

*8: Support 1080/60p signal only.

<div> <div>LED</div> <div>65"</div> <div>LED</div> <div>50"</div> <div>LED</div> <div>42"</div> </div>				
Model no.	TH-65LFE7E	TH-50LFE6E		TH-42LFE6E
DISPLAY	Screen Size (Diagonal)/Aspect Ratio	65-inch (1,639 mm)/16:9	50-inch (1,257 mm)/16:9	42-inch (1,067 mm)/16:9
	Panel Type	MVA/E-LED	VA Panel/E-LED	VA Panel/E-LED
	Effective Display Area (W x H)	1,428 x 803 mm	1,095 x 616 mm	930 x 523 mm
	Number of Pixels (H x V)	1,920 x 1,080 pixels	1,920 x 1,080 pixels	1,920 x 1,080 pixels
	Brightness	350 cd/m ² (Typ)	350 cd/m ² (Typ)	350 cd/m ² (Typ)
	Contrast Ratio	5,000:1	5,000:1	5,000:1
	Response Time	6.5 ms (G to G)	6.5 ms (G to G)	9.5 ms (G to G)
	Viewing Angle	176°/176°	176°/176°	176°/176°
TERMINAL	VIDEO In	—	—	—
	Audio In (L/R)	—	—	—
	HDMI In	HDMI Type A Connector x 2	HDMI Type A Connector x 1	HDMI Type A Connector x 1
	Component/RGB In	—	—	—
	Audio In (L/R)	—	—	—
	DVI-D In	DVI-D 24-pin x 1	DVI-D 24-pin x 1	DVI-D 24-pin x 1
	Audio In (L/R)	M3 Jack x 1 (Shared with PC In)	M3 Jack x 1 (Shared with PC In)	M3 Jack x 1 (Shared with PC In)
	DVI-D Out	—	—	—
	PC In	Mini D-Sub 15-pin x1 (Female)	Mini D-Sub 15-pin x1 (Female)	Mini D-Sub 15-pin x1 (Female)
	Audio In (L/R)	M3 Jack x 1 (Shared with DVI-D In)	M3 Jack x 1 (Shared with DVI-D In)	M3 Jack x 1 (Shared with DVI-D In)
	Audio Out (L/R)	M3 Jack x 1	M3 Jack x 1	M3 Jack x 1
	Serial In	D-Sub 9-pin x 1, RS-232C Compatible	D-Sub 9-pin x 1, RS-232C Compatible	D-Sub 9-pin x 1, RS-232C Compatible
	LAN	RJ45 x 1 10BASE-T/100BASE-TX, Compatible with PLink™	RJ45 x 1 10BASE-T/100BASE-TX, Compatible with PLink™	RJ45 x 1 10BASE-T/100BASE-TX, Compatible with PLink™
	Function Slot	—	—	—
GENERAL	Power Requirements	220-240 V AC, 50 Hz/60 Hz	220-240 V AC, 50 Hz/60 Hz	220-240 V AC, 50 Hz/60 Hz
	Power Consumption	T.B.D.	90 W	65 W
	Power Off Condition	T.B.D.	Approx. 0.5 W	Approx. 0.5 W
	Stand-by Condition	T.B.D.	Approx. 0.5 W	Approx. 0.5 W
	Dimensions (W x H x D)	1,458 x 840 x 52 mm (T.B.D.)	1,121 x 655 x 49 mm	957 x 564 x 49 mm
	Carton Size (W x H x D)	1,574 x 949 x 227 mm (T.B.D.)	1,461 x 753 x 127 mm	1,236 x 662 x 127 mm
	Bezel Width	10.8 mm (Left/Right/Top), 17.9 mm (Bottom) [T.B.D.]	9.0 mm (Left/Right/Top), 10 mm (Bottom)	9.0 mm (Left/Right/Top), 10 mm (Bottom)
	Weight	Approx. 34.0 kg (T.B.D.)	Approx. 18.0 kg	Approx. 13.5 kg
	Gross Weight	Approx. 40.0 kg (T.B.D.)	Approx. 22.0 kg	Approx. 17.0 kg
	Pitch for Wall-Hanging	VESA Compliant 400 mm x 400 mm	VESA Compliant 400 mm x 200 mm	VESA Compliant 400 mm x 400 mm
	Built-in Speakers	20 W [10 W + 10 W] (10 % THD)	10 W [5 W + 5 W] (10 % THD)	10 W [5 W + 5 W] (10 % THD)
	Operating Environment	Temperature: 0 °C to 40 °C, Humidity: 20 % to 80 % (Non condensation)		Temperature: 0 °C to 40 °C, Humidity: 20 % to 80 % (Non condensation)
	Storage Environment	Temperature: -20 °C to 60 °C, Humidity: 20 % to 80 % (Non condensation)		Temperature: -20 °C to 60 °C, Humidity: 20 % to 90 % (Non condensation)
OPTION	Pedestal	TY-ST65PE7	TY-ST42PE6	TY-ST42PE6

LED backlight provide light weight, a thin profile, and low power consumption

Detailed Full-HD picture quality and the beautiful images in large spaces. The use of an LED backlight allows signage to be used for long periods with excellent visibility and low power consumption, to help reduce running costs.



Text and intricate patterns are crisply displayed.

A stylish design with large screen and narrow 9 mm* bezel

The stylish design combines a 9 mm bezel and a depth of only 49 mm*. There is less visual bulk, so the display seems to blend into its surroundings. This makes the image stand out even more, for greater, eye-catching visibility.

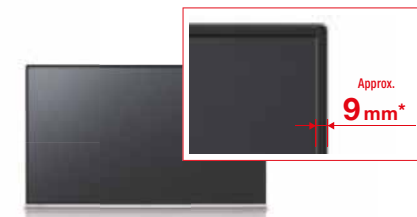

* LFE6 Series only. (TH-65LFE7 is 10.8 mm bezel width and 52 mm depth.)

Standard-equipped input/output terminals for signage use

The input/output terminals (HDMI, DVI-D, PC-IN) and control terminals (RS232C, LAN) needed for signage use are provided as standard equipment.

Built-in Speaker

The speaker is built into the rear of the display. There is no need for external speakers when using content that has a soundtrack.



	Indoor								Video Wall				Outdoor		Multi Touch Screen			Network			Standard		
	TH-80LF50	TH-70LF50	TH-55LF60	TH-47LF60	TH-42LF60	TH-55LF6	TH-47LF6	TH-42LF6	TH-55LFFV50		TH-55LFFV5	TH-47LFFV5	TH-47LFX60	TH-47LFX6	TH-80LFB70	TH-65LFB70	TH-50LFB70	TH-80LFC70	TH-65LFC70	TH-50LFC70	TH-65LFE7	TH-50LFE6	TH-42LFE6
Size (inch)	80	70	55	47	42	55	47	42	55		55	47	47	47	80	65	50	80	65	50	65	50	42
SPECIFICATION	Touch Operation	—	—	—	—	—	—	—	—		—	—	—	—	Yes	Yes	Yes	—	—	—	—	—	—
	IP Rating	—	—	—	—	—	—	—	—		—	—	IP55	IP44	—	—	—	—	—	—	—	—	—
	24/7 Operation	Yes	Yes	Yes	Yes	Yes	Yes	Yes	Yes	Yes	Yes	Yes	—	—	—	—	—	—	—	—	—	—	—
	DIGITAL LINK	—	—	Yes	Yes	Yes	Yes	Yes	—		—	—	Yes	Yes	Yes	Yes	Yes	Yes	Yes	Yes	—	—	—
	Anti-Glare	—	—	—	—	—	—	—	—		Yes	Yes	—	—	Yes	Yes	Yes	Yes	Yes	Yes	—	—	—
INSTALLATION	Outdoor Installation	—	—	—	—	—	—	—	—		—	—	Yes	Yes	—	—	—	—	—	—	—	—	—
	Video Wall	Yes	Yes	Yes	Yes	Yes	Yes	Yes	Yes	Yes	Yes	Yes	Yes	Yes	—	—	—	—	—	—	Yes	Yes*	Yes*
	Portrait	Yes	Yes	Yes	Yes	Yes	Yes	Yes	Yes	Yes	Yes	Yes	Yes	Yes	—	—	—	—	—	—	Yes (T.B.D.)	—	—
	Pre Calibration	—	—	—	—	—	—	—	Yes		Yes	Yes	—	—	—	—	—	—	—	—	—	—	—
	Narrow Bezel	Yes	Yes	Yes	Yes	Yes	Yes	Yes	Yes	Yes	Yes	Yes	—	—	—	—	—	—	—	—	Yes	Yes	Yes
	Fan less Design	Yes	Yes	Yes	Yes	Yes	Yes	Yes	Yes	—	—	—	—	—	—	—	—	—	—	—	Yes	Yes	Yes
	SLOT2.0	Yes	Yes	—	—	—	—	—	—		—	—	—	—	Yes	Yes	Yes	Yes	Yes	Yes	—	—	—
	Ceiling-Suspension	Yes	Yes	Yes	—	—	Yes	—	—		—	—	—	—	—	—	—	—	—	—	—	—	—
FUNCTION	Monitor Out	—	—	—	—	—	—	—	—		—	—	—	—	Yes	Yes	Yes	Yes	Yes	Yes	—	—	—
	Built-in Whiteboard	—	—	—	—	—	—	—	—		—	—	—	—	Yes	Yes	Yes	—	—	—	—	—	—
	Memory Viewer	—	—	—	—	—	—	—	—		—	—	—	—	Yes	Yes	Yes	Yes	Yes	Yes	—	—	—
	Wireless Function	—	—	—	—	—	—	—	—		—	—	—	—	Yes	Yes	Yes	Yes	Yes	Yes	—	—	—
	Micacast™	—	—	—	—	—	—	—	—		—	—	—	—	Yes	Yes	Yes	Yes	Yes	Yes	—	—	—
	LAN Control	Yes	Yes	Yes	Yes	Yes	Yes	Yes	Yes	Yes	Yes	Yes	Yes	Yes	Yes	Yes	Yes	Yes	Yes	Yes	Yes	Yes	Yes
	Input Search	Yes	Yes	Yes	Yes	Yes	Yes	Yes	—	—	—	—	Yes	Yes	Yes	Yes	Yes	Yes	Yes	Yes	Yes	Yes	Yes
	Digital Zoom	Yes	Yes	Yes	Yes	Yes	Yes	Yes	Yes		Yes	Yes	Yes	Yes	Yes	Yes	Yes	Yes	Yes	Yes	Yes	Yes	Yes
	Seam Hides Video Off Mode	Yes	Yes	Yes	Yes	Yes	Yes	Yes	Yes	Yes	Yes	Yes	Yes	Yes	—	—	—	—	—	—	Yes	Yes	Yes
	Daisy-Chain Connection	Yes	Yes	Yes	Yes	Yes	Yes	Yes	Yes	Yes	Yes	Yes	—	—	—	—	—	—	—	—	—	—	—
	Power on Screen Delay	Yes	Yes	Yes	Yes	Yes	Yes	Yes	Yes	Yes	Yes	Yes	Yes	Yes	—	—	—	—	—	—	Yes	Yes	Yes
	Display ID Control	Yes	Yes	Yes	Yes	Yes	Yes	Yes	Yes	Yes	Yes	Yes	Yes	Yes	Yes	Yes	Yes	Yes	Yes	Yes	Yes	Yes	Yes
	PC/DVI-D Power Management	Yes	Yes	Yes	Yes	Yes	Yes	Yes	Yes	Yes	Yes	Yes	Yes	Yes	Yes	Yes	Yes	Yes	Yes	Yes	Yes	Yes	Yes
	HDMI Power Management	—	—	—	—	—	—	—	—		—	—	—	—	Yes	Yes	Yes	Yes	Yes	Yes	—	—	—
	Audio Input Select	—	—	—	—	—	—	—	—		—	—	—	—	Yes	Yes	Yes	Yes	Yes	Yes	—	—	—
	Picture in Picture	—	—	—	—	—	—	—	—		—	—	—	—	Yes	Yes	Yes	Yes	Yes	Yes	—	—	—
	Brightness Sensor	Yes	Yes	Yes	Yes	Yes	Yes	Yes	—		—	—	Yes	Yes	Yes	Yes	Yes	Yes	Yes	Yes	Yes	Yes	Yes
	Power Save Mode	Yes	Yes	Yes	Yes	Yes	Yes	Yes	Yes	Yes	Yes	Yes	Yes	Yes	Yes	Yes	Yes	Yes	Yes	Yes	Yes	Yes	Yes
	Input/Button Lock	Yes	Yes	Yes	Yes	Yes	Yes	Yes	Yes	Yes	Yes	Yes	Yes	Yes	Yes	Yes	Yes	Yes	Yes	Yes	Yes	Yes	Yes
	Remocon User Level	Yes	Yes	Yes	Yes	Yes	Yes	Yes	—		—	—	Yes	Yes	Yes	Yes	Yes	Yes	Yes	Yes	Yes	Yes	Yes
	Weekly Command Timer	Yes	Yes	Yes	Yes	Yes	Yes	Yes	—		—	—	Yes	Yes	Yes	Yes	Yes	Yes	Yes	Yes	Yes	Yes	Yes
	Screen Saver	Yes	Yes	Yes	Yes	Yes	Yes	Yes	Yes	Yes	Yes	Yes	Yes	Yes	Yes	Yes	Yes	Yes	Yes	Yes	Yes	Yes	Yes
	Outdoor Mode	—	—	—	—	—	—	—	—		—	—	Yes	Yes	—	—	—	—	—	—	—	—	—

* Only compatible with 5 displays horizontally.